



July 24, 2020

Subject: **Orientation Information**



Welcome to Hull Prairie Intermediate School and the 2020-2021 school year. We are excited to be returning after a challenging and turbulent spring and summer. The following communication focuses on student orientation to HPI and information needed for the start of the school year. Please do not hesitate to reach out if you have questions, concerns or ideas on how we can better serve you.

Student Orientation Information	
Friday, July 24	
Families will receive an email that will contain information regarding Student Orientation, their child's homeroom teacher and team assignment.	
Monday, August 10	
Faust & Shaffer Caseloads 8:00-10:00am	
Tuesday, August 11	Wednesday, August 12
6Blue & 6Orange Teams (HR) 8:00-8:40am Stout & Mitchell 8:45-9:25 Kleman & Soltis 9:30-10:10 Budnick & Beck 10:15-10:55 Printy & Kuns 6Green & 6Red Teams 12-12:40pm Piotrowicz & Wedge 12:45-1:25 Caswell & Andrews 1:30-2:10 Boden & Kelly 2:15-2:55 Link & Baum	5Blue & 5Orange Teams 8:00-8:40am Sanford & Wilson 8:45-9:25 Duesing & Roach 9:30-10:10 Boros & Ferrara 10:15-10:55 Switala & Hilt 5Green & 5Red Teams 12-12:40pm Schoen & Cribbs 12:45-1:25 Shumaker & Butts 1:30-2:10 Bock & Swanson 2:15-2:55 Bierley & Rosebrock
Visitor Guidelines for Student Orientation	
<ul style="list-style-type: none"> • Face coverings are required to enter and remain in the building during orientation. • Only 1 adult per student or family of multiples will be permitted in the building at one time. • Multiples (twins, triplets or quads) may attend the same orientation session. • Please maintain social distancing between families. • Parking & Entering/Exiting the Building <ul style="list-style-type: none"> ○ Blue & Red Teams must use the staff parking lot and enter/exit the building through the main entrance (Door #1). ○ Orange & Green Teams must use the visitor and bus parking lots and enter/exit through the bus entrance (Door #15). 	



Schedule Information

How Do I Read My Child's Schedule?

Receiving a printed schedule at orientation can be overwhelming for our students and their families. Below are a few pointers on how to read your child's schedule when you arrive.

Period	Term	Course	Teacher	Room	
1(A-B)	20-21	HPI Homeroom	Mitchell, Jennifer	O6	1
2(A-B)	20-21	Science	Beck, Jeff	O9	2
3(A-B)	20-21	Social Studies	Kuns, Megan *	O8	3
4(A-B)	20-21	Mathematics	Soltis, Christopher	O7	4
5(A-B)	Q1	IDEA	Schmidt, Lindsay	STEM 2	5
6(A-B)	20-21	Lunch	Staff , Staff	Commons	6
7(A-B)	20-21	Jacket Period	Mitchell, Jennifer	O6	7
8(A-B)	20-21	English Language Arts	Mitchell, Jennifer	O6	8

Indicates Time of Day (Period)
A-B (Every Day)

20-21 Year-long Course
Q1, Q2, Q3, Q4 Quarter-long Classes

During the first quarter, this particular student will attend IDEA during 5th period.

General Information

Important Upcoming Dates

- August 11 6th Grade Student Orientation Day
- August 12 5th Grade Student Orientation Day
- August 20 Staggered Start – 6th Grade Only**
- August 21 Staggered Start – 5th Grade Only**
- August 24 Remote Learning Day**
- August 25 All Students Attend**

Building Hours

- Commons Open for Breakfast 7:00 am – 7:45 am (Regular Hours) or 9:00 am – 9:45 am (2-hour delay)
- Academic Wing Open 7:30 am or 9:30 am (2-hour delay)
- Regular Building Hours 7:50 am – 2:45 pm
- 2-Hour Delay 9:50 am – 2:45 pm
- Commons Open for PM Snack 2:45 pm – 2:55 pm

Weekly Student Schedule

- Mondays Remote Learning
- Tuesdays-Fridays In-Session

School Fees

5th/6th Grade \$51.00 (Total)

Itemized Breakdown of School Fee

- Project-based Learning \$3.00
- Math in Focus Workbook \$15.00
- Science Lab \$2.00
- Team Folder \$2.00
- Periodicals \$6.00
- Creative Arts \$23.00

2020-21 Hull Prairie School Supply List

- Designated pair of gym shoes (non-skid/non-black bottom) - Street shoes are not permitted on the gym floor.
- Work T-shirt (Art, STEM & IDEA)
- 3-ring Binder (2" or 3") w/Supply Pouch & Tabbed Subject Dividers (5)
- 1 pack loose-leaf lined paper
- 2 24 packs of #2 wooden pencils, extra erasers, and handheld sharpener **(1 Pack will be Collected by HR teacher)**
- Colored pencils - 12 pack
- 4 glue sticks **(2 sticks will be Collected by HR teacher)**
- 1 pair of scissors
- 1 pair of earbuds
- 4 pack dry erase markers w/sock or eraser
- 2 highlighters
- 4 composition notebooks (100 sheets)
- 2 Bleach Wipe Container **(Collected by HR teacher)**
- 2 box of facial tissues - **(Collected by HR teacher)**
- 4 rolls scotch tape - **(Collected by HR teacher)**
- Pack of Post-its
- **6th Grade Only** - Calculator (Choose one. Calculator options can be used in grades 6-8.)
 - Texas Instrument TI-30Xa or Texas Instrument TI-30XIIS

School Transportation

Registration is required to have bus transportation for the 2020-21 school year. Information has already been sent out from the transportation department. If you have not received this information please contact the Transportation Director, Courtney Parr (cparr@perrysburgschools.net).

Drop-off/Pick-up Area Information

Whenever it is not possible for a student to take school transportation, parents and guardians **must** adhere to our traffic patterns in the drop-off/pick-up area to ensure the safety of our students and to keep traffic flowing. Parents and guardians can familiarize themselves with this process by reviewing the attached site map or by visiting the HPI web page to preview how traffic will flow around the building each morning and afternoon.

Morning Guidelines

- **DRIVERS SHOULD NEVER BE ON THEIR CELL PHONES!**
- Students should be ready to exit their vehicle from the **PASSENGER SIDE** before entering pick-up/drop-off zone.
- **YOU DO NOT NEED TO DROP OFF YOUR CHILD IN FRONT OF THE MAIN DOORS. THEY WILL BE "OK" WALKING FROM THE FRONT, MIDDLE OR BACK OF THE DROP-OFFLINE.**
- Drivers should always pull forward whenever safely possible to do so.
- Students who arrive after 7:40 am must enter the building through the main office.
- Students are expected to be in their classrooms by 7:45 am.

After School Guidelines

- **DRIVERS SHOULD NEVER BE ON THEIR CELL PHONES!**
- Students should be ready to enter their vehicle safely and quickly when they are in the pick-up/drop-off zone.
- Students should always enter on the school side of the vehicle.
- Vehicles should always pull forward whenever safely possible to do so.

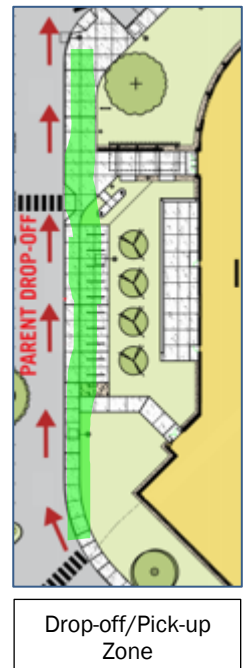

Students Walking to/from HPI

Hull Prairie and Roachton Roads are zoned 55 mph speed limits. If your child walks to and from HPI, please remind them to use extreme caution when walking along and crossing Hull Prairie or Roachton Road. Also note that there are no crossing guards on Canterbury Boulevard, the crosswalks at the round-a-bout, or the Hawthorne crosswalk.

Other Safety Reminders

- The round-a-bout is **not** a safe area to drop off or pick up a child.
- **Do not pick up or drop off your child on Canterbury Boulevard, Roachton Road or Hull Prairie Road.** This creates an unsafe environment for everyone.
- For obvious reasons, drivers should never be on their cell phones when entering the drop-off/pick-up area. Not only is this distracted driving practice unsafe for your family, it also puts our students, other families, and our staff in danger.

HPI Traffic Patterns

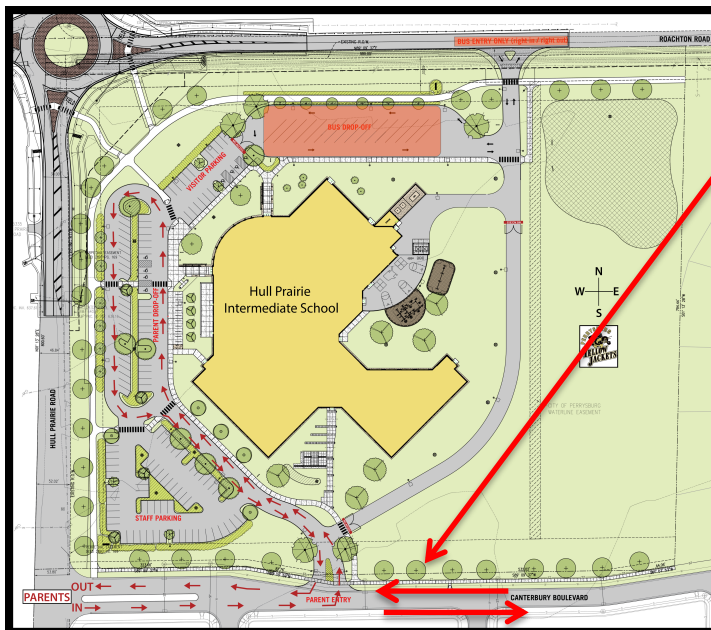

When arriving early at the end of the school day, please drive into the Canterbury development and then turn around so you are turning right into the school property. This will help keep Canterbury Blvd. clear of traffic in case of an emergency at the end of the day.

We sincerely thank you for choosing our school district and trusting us with the responsibility of educating your child. We strive each day to ensure all students achieve their greatest potential. If at any time you have questions, concerns, or ideas on how we can better serve you, please do not hesitate to contact us. Best wishes for a great school year. Go Jackets!

In Service,

Scott A. Best
Principal

Laura Davidson
Assistant Principal

Liza Brown
Dean of Students

Chris Harper
5th Grade School Counselor

Nicole Wagner
6th Grade School Counselor

Here are some helpful links:

[OTC Medication Form](#)

[Online Payments](#)